

MAIN FLOOR
731 SQ. FT.
8'-11" CEILING HEIGHT

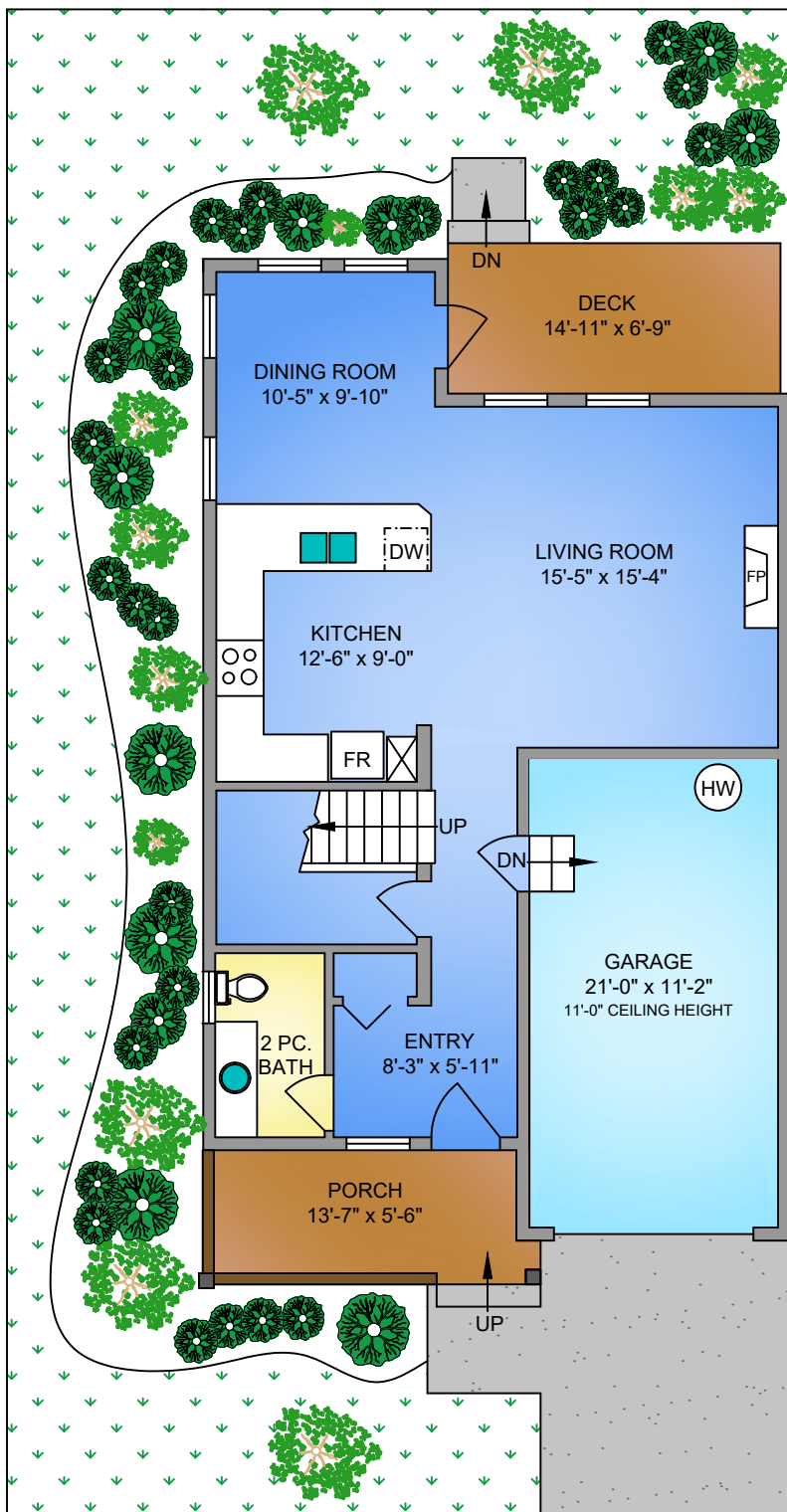

UPPER FLOOR
936 SQ. FT.
8' CEILING HEIGHT

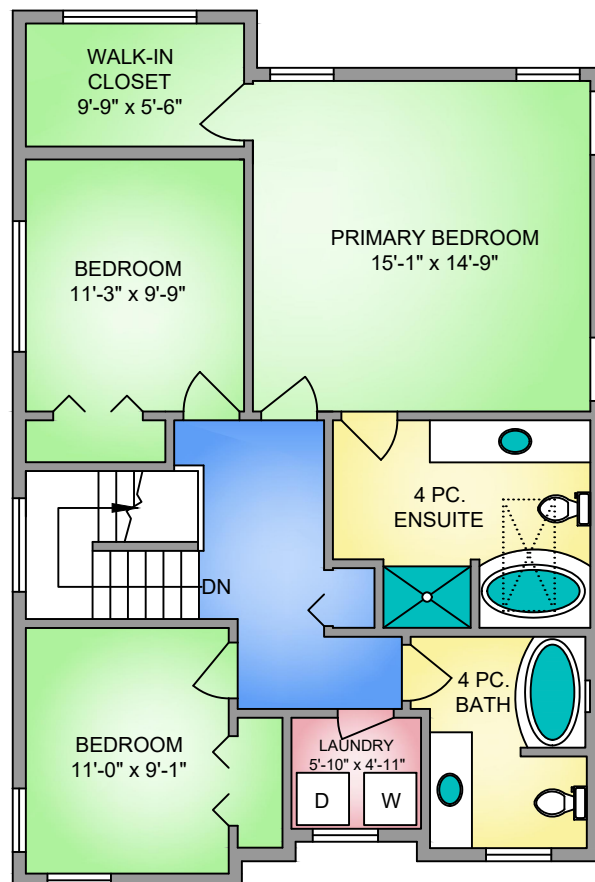

NORTH

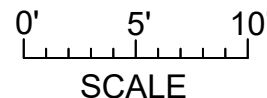
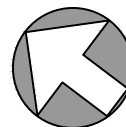

UNIT 102 - 6591 ARRANWOOD DRIVE			
MAY 20, 2021			
PREPARED FOR THE EXCLUSIVE USE OF MARILYN BALL			
PLANS MAY NOT BE 100% ACCURATE, IF CRITICAL BUYER TO VERIFY.			
FLOOR	AREA (SQ. FT.)		
	FINISHED	GARAGE	DECK / PORCH
MAIN	731	245	180
UPPER	936	-	-
TOTAL	1667	245	180



250-884-9753
 matt@propermeasure.com
 www.propermeasure.com